

圓頭十字螺絲

WA716

樹脂

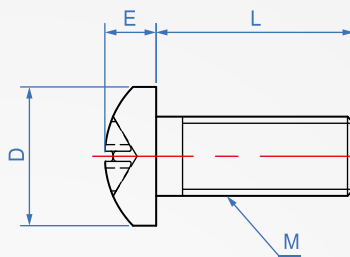
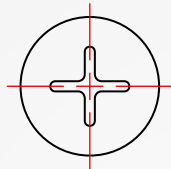

材質

PPGF(PP+玻纖)

PPS(聚苯硫化物)

PEEK(聚醚醚銅)

How to order

WA716 - M3 - 10 -

TYPE 螺紋 長度

選擇材質

PPGF(PP+玻纖)..... PPGF

PPS(聚苯硫化物)..... PPS

PEEK(聚醚醚銅)..... PEEK

1

2

單位:mm

M 螺紋	螺距 Pitch	L 選擇長度							D	E	每包數量
M1.2	0.25	2.5	4					1.8	0.5	50	
M1.4	0.3	2.5	4					2			
M1.6	0.35	2.5	4					2.3			
M1.7	0.35	2.5	4					2.5			
M2	0.4	6						3.5	1.3		
M3	0.5	10	15					5.5	2		
M4	0.7	10	15	20	25	30		7	2.6		
M5	0.8	10	15	20	25	30		9	3.3		
M6	1	10	15	20	25	30	35	40	10.5		3.9

版權所有
重製必究