

固定把手

DD941

S形

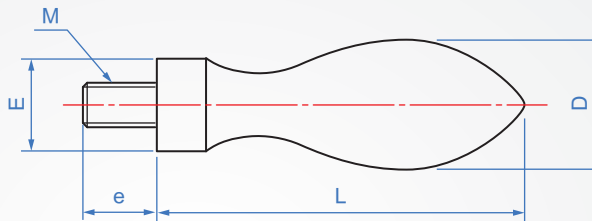
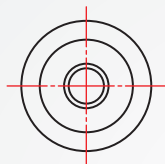

材質

表面處理

鐵 (ST)

CR 鍍亮鉻

EL 鍍霧銀

How to order

DD941 - M4 -

TYPE 螺紋

選擇表面處理

鍍亮鉻.....

鍍霧銀.....

1

單位:mm

M 螺紋	D	L	e	E
M4	10	32	7	7
M5	13	40	9	8
M6	16	50	9	10
M8	20	64	13	13
M10	25	80	14	16
M12	32	100	21	20
M16	36	112	26	22