

十字型浮昇銷

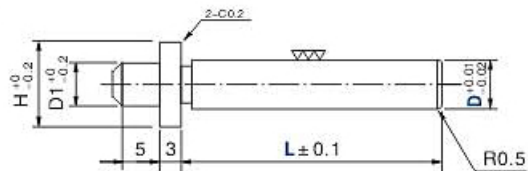

LPH



M 材質	SK4
H 硬度	53~58HRC

(頭緣部淬火處理硬度在45HRC以下)

十字型浮昇銷

H	D1	Catalog No.		L
		Type	D	
5	3	LPH	3	10 15 20 25 30 35
6	4		4	10 15 20 25 30 35 40
7	5		5	15 20 25 30 35 40
8	6		6	15 20 25 30 35 40
10	8		8	20 25 30 35 40



訂購範例
Order

Catalog No.	-	L	-	A
GLP 6	-	25	-	A1.0
LPH 6	-	25		
LP 6	-	25		



交 期
Delivery 4 天出貨