

皿頭十字螺絲

WA717 樹脂

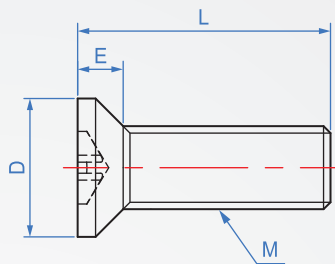
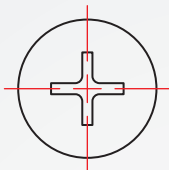

材質

PPGF(PP+玻纖)

PPS(聚苯硫化合物)

PEEK(聚醚醚銅)

How to order

WA717 - M4 - 15 -
TYPE 螺紋 長度

選擇材質

PPGF(PP+玻纖).....
 PPS(聚苯硫化合物).....
 PEEK(聚醚醚銅).....

1

2

單位 :mm

M 螺紋	螺距 Pitch	L 選擇長度						D	E	每包數量
M1.6	0.35	2.5	4				2.3	1	50	
M1.7	0.35	2.5	4				2.5			
M2	0.4	6					4	1.2	20	
M3	0.5		10	15			6	1.75		
M4	0.7		10	15	20	25	30	2.3		
M5	0.8		10	15	20	25	30	9.3	10	
M6	1		10	15	20	25	30	11.3		3.3