

Toothed idler

DU300 5GT

Belt Width(mm)	10	15	20	25
Common size	A=11 W=16	A=17 W=22	A=22 W=27	A=27 W=32

Main Part	Flang	Finish	Code
aluminum alloy	aluminum	Clear anodizing	AS
		Black anodized	AB
		Electroless nickel	AK
		Hard anodized	AN
S45C	Iron	Byed black	TB
		Electroless Nickel	TN

Center bearing



Two side bearing

Single bearing Retaining ring

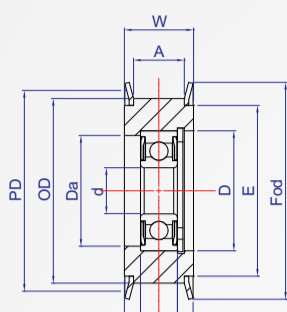

Single bearing

Two bearing Retaining ring

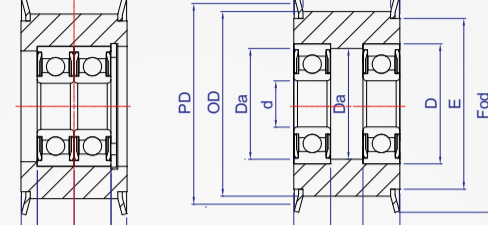

Two bearing

How to order



Choose a finish

Aluminum + White Anodized.....	AS
Aluminum + Black Anodized.....	AB
Aluminum + hardened anode.....	AK
Aluminum + Electroless Nickel.....	AN
S45C+ dyed black.....	TB
S45C+ Electroless Nickel.....	TN

Kind	Number of teeth	Tooth width	d	P.D	O.D	E	Fod	Y Single bearing						Z Two Bearing															
								No.	B	D	Da Max	e	C ring	No.	B	D	Da Max												
																		Unit : mm											
15	5GT-10 A=11 W=16	Y (Centered)	6	23.87	22.73	18	28	696ZZ	2pc	5	15	13.4	3	R15	606ZZ	2pc	6	17	15										
16				25.46	24.32	20	32	606ZZ	1pc	6	17	15	5	R17															
18				28.65	27.5	22.5	35	698ZZ	2pc	6	19	17	5	R19						698ZZ	6	19	17						
20				31.83	30.69	24	35																						
22				35.01	33.87	28	40	628ZZ	2pc	8	24	22	4	R24						608ZZ	7	22	20						
24				38.2	37.05	30	42																						
25		39.79	38.65	30	45	6000ZZ	2pc	8	26	24	4	R26	6900ZZ	6	22	20													
26		41.38	40.24	34	47																								
28		44.56	43.42	37	49	6200ZZ	2pc	9	30	25	3.5	R30	6200ZZ	—	—	—													
30		47.75	46.6	40	52																								
32		50.93	49.79	40	55	6201ZZ	1pc	10	32	27	3	R32	6001ZZ	—	—	—													
34		54.11	52.97	44	62																								
35		55.7	54.56	44	65	6202ZZ	1pc	10	32	27	6	R32	6001ZZ	8	28	26													
36		57.3	56.15	45	65																								
38		60.48	59.34	52.5	67.5	6202ZZ	1pc	11	35	30	5.5	R35	6002ZZ	9	32	30													
40		63.66	62.52	59	73																								
42	66.85	65.7	59	73	6302ZZ	1pc	13	42	36	7	R42	6202ZZ	11	35	30														
44	70.03	68.89	59	73																									
18	5GT-15 A=17 W=22	Y (Centered)	8	28.65	27.5	22.5	32	698ZZ	2pc	6	19	17	5	R19	698ZZ	2pc	6	19	17										
20				31.83	30.69	24	35																						
22				35.01	33.87	28	40	628ZZ												2pc	8	24	22	3	R24	608ZZ	7	22	20
24				38.2	37.05	30	42																						
25				39.79	38.65	30	45	6000ZZ												2pc	8	26	24	3	R26	6900ZZ	6	22	20
26				41.38	40.24	34	47																						
28		44.56	43.42	37	49	6200ZZ	2pc	9	30	25	6.5	R30	6200ZZ	9	30	25													
30		47.75	46.6	40	52																								
32		50.93	49.79	40	55	6201ZZ	1pc	10	32	27	6	R32	6001ZZ	8	28	26													
34		54.11	52.97	44	62																								
35		55.7	54.56	44	65	6202ZZ	1pc	11	35	30	5.5	R35	6002ZZ	9	32	30													
36		57.3	56.15	45	65																								
38		60.48	59.34	52.5	67.5	6302ZZ	1pc	13	42	36	7	R42	6202ZZ	11	35	30													
40		63.66	62.52	59	73																								
42		66.85	65.7	59	73	6302ZZ	1pc	13	42	36	7	R42	6202ZZ	11	35	30													
44		70.03	68.89	59	73																								
18	5GT-20 A=22 W=27	Y (Centered)	8	28.65	27.5	22.5	32	698ZZ	2pc	6	19	17	7.5	R19	698ZZ	2pc	6	19	17										
20				31.83	30.69	24	35																						
22				35.01	33.87	28	40	628ZZ												2pc	8	24	22	5.5	R24	608ZZ	7	22	20
24				38.2	37.05	30	42																						
25				39.79	38.65	30	45	6000ZZ												2pc	8	26	24	5.5	R26	6900ZZ	6	22	20
26				41.38	40.24	34	47																						
28		44.56	43.42	37	49	6200ZZ	2pc	9	30	25	4.5	R30	6200ZZ	9	30	25													
30		47.75	46.6	40	52																								
32		50.93	49.79	40	55	6201ZZ	1pc	10	32	27	3.5	R32	6201ZZ	10	32	27													
34		54.11	52.97	44	62																								
35		55.7	54.56	44	65	6302ZZ	1pc	13	42	36	7	R42	6202ZZ	11	35	30													
36		57.3	56.15	45	65																								
38		60.48	59.34	52.5	67.5	6302ZZ	1pc	13	42	36	7	R42	6202ZZ	11	35	30													
40		63.66	62.52	59	73																								
42		66.85	65.7	59	73	6302ZZ	1pc	13	42	36	7	R42	6202ZZ	11	35	30													
44		70.03	68.89	59	73																								
18	5GT-25 A=22 W=27	Z (Sides)	8	28.65	27.5	22.5	32	698ZZ	2pc	6	19	17	5	R19	698ZZ	2pc	6	19	17										
20				31.83	30.69	24	35																						
22				35.01	33.87	28	40	628ZZ												2pc	8	24	22	3	R24	608ZZ	7	22	20
24				38.2	37.05	30	42																						
25				39.79	38.65	30	45	6000ZZ												2pc	8	26	24	3	R26	6900ZZ	6	22	20
26				41.38	40.24	34	47																						
28		44.56	43.42	37	49	6200ZZ	2pc	9	30	25	4.5	R30	6200ZZ	9	30	25													
30		47.75	46.6	40	52																								
32		50.93	49.79	40	55	6201ZZ	1pc	10	32	27	3.5	R32	6201ZZ	10	32	27													
34		54.11	52.97	44	62																								
35		55.7	54.56	44	65	6202ZZ	1pc	11	35	30	5	R35	6202ZZ	11	35	30													
36		57.3	56.15	45	65																								
38		60.48	59.34	52.5	67.5	6202ZZ	1pc	11	35	30	5	R35	6202ZZ	11	35	30													
40		63.66	62.52	59	73																								
42		66.85	65.7	59	73	6202ZZ	1pc	11	35	30	5	R35	6202ZZ	11	35	30													
44		70.03	68.89	59	73																								

※ 10mm: (15*teeth) have two bearings °
 15mm: (18*~25*teeth) have two bearings °
 20mm: (18*~35*teeth) have two bearings °
 25mm: (18*~44*teeth) have two bearings °