

Toothed idler

DU300 AT5

Belt Width(mm)	10	15	20	25
Common size	A=11 W=16	A=17 W=22	A=22 W=27	A=27 W=32

Main Part	Flang	Finish	Code
aluminum alloy	aluminum	Clear anodizing	AS
		Black anodized	AB
		Electroless nickel	AK
		Hard anodized	AN
S45C	Iron	Byed black	TB
		Electroless Nickel	TN

Y Single bearing Retaining ring

Z Two bearing Retaining ring

Center bearing



Two side bearing

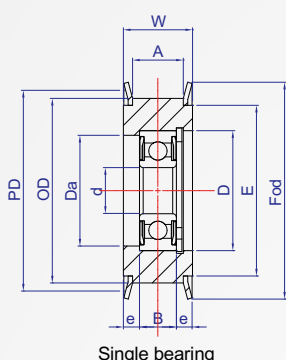

Single bearing

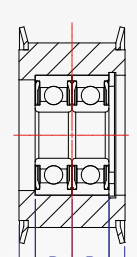

Two bearing

How to order



- Choose a finish
- Aluminum + White Anodized..... **AS**
 - Aluminum + Black Anodized..... **AB**
 - Aluminum + hardened anode..... **AK**
 - Aluminum + Electroless Nickel..... **AN**
 - S45C+ dyed black..... **TB**
 - S45C+ Electroless Nickel..... **TN**

Number of teeth	Tooth width	Kind	d	P.D	O.D	E	Fod	Y Single bearing						Z Two Bearing							
								No.	B	D	Da Max	e	C ring	No.	B	D	Da Max				
15	AT5-10 A=11 W=16	Y (Centered)	6	23.87	22.65	18	28	696ZZ	2pc	5	15	13.4	3	R15	606ZZ	2pc	6	17	15		
16				25.46	24.2	20	32	606ZZ	1pc	6	17	15	5	R17							
18		Z (Sides)	8	28.65	27.4	22.5	32	698ZZ	2pc	6	19	17	5	R19	698ZZ	6	19	17			
20				31.83	30.6	24	35												628ZZ	8	24
22		Y (Centered)	10	10	35.01	33.75	28	40	6000ZZ	2pc	8	26	24	4	R26	6900ZZ	6	22	20		
24					38.2	36.95	30	42												6200ZZ	9
25		Z (Sides)	12	12	39.79	38.55	34	47	6201ZZ	1pc	10	32	27	3	R32	6002ZZ	9	32	30		
26					41.38	40.15	37	49												6002ZZ	9
28		AT5-15 A=17 W=22	Y (Centered)	8	44.56	43.35	40	52	6200ZZ	2pc	6	19	17	5	R19	698ZZ	2pc	6	19	17	
30					47.75	46.5	40	55													6201ZZ
32			Z (Sides)	10	10	50.93	49.7	30	45	6000ZZ	2pc	8	26	24	3	R26	6900ZZ	6	22	20	
34						54.11	52.9	44	62												6200ZZ
35			Y (Centered)	12	12	55.7	54.45	34	47	6200ZZ	2pc	9	30	25	6.5	R30	6200ZZ	9	30	25	
36						57.3	56.05	45	65												6201ZZ
38			Z (Sides)	15	15	60.48	59.25	52.5	67.5	6202ZZ	1pc	11	35	30	5.5	R35	6002ZZ	9	32	30	
40						63.66	62.45	59	73												6202ZZ
42	AT5-20 A=22 W=27		Y (Centered)	8	66.85	65.6	59	73	698ZZ	2pc	6	19	17	7.5	R19	698ZZ	2pc	6	19	17	
44					70.03	68.8	59	73													628ZZ
22			Z (Sides)	10	10	35.01	33.75	28	40	6000ZZ	2pc	8	26	24	5.5	R26	6900ZZ	6	22	20	
24						38.2	36.95	30	42												6200ZZ
25			Y (Centered)	12	12	39.79	38.55	34	47	6200ZZ	2pc	10	32	27	3.5	R32	6201ZZ	10	32	27	
26						41.38	40.15	37	49												6201ZZ
28			Z (Sides)	15	15	44.56	43.35	40	52	6200ZZ	2pc	10	32	27	3.5	R32	6201ZZ	10	32	27	
30						47.75	46.5	44	62												6302ZZ
32		AT5-25 A=27 W=32	Y (Centered)	8	50.93	49.7	30	45	6000ZZ	2pc	6	19	17	5	R19	698ZZ	2pc	6	19	17	
34					54.11	52.9	44	62													6201ZZ
35			Z (Sides)	10	10	55.7	54.45	34	47	6200ZZ	2pc	8	26	24	3	R26	6900ZZ	6	22	20	
36						57.3	56.05	45	65												6200ZZ
38			Y (Centered)	12	12	60.48	59.25	52.5	67.5	6202ZZ	1pc	11	35	30	5	R35	6202ZZ	11	35	30	
40						63.66	62.45	59	73												6202ZZ
42			AT5-25 A=27 W=32	Y (Centered)	8	66.85	65.6	59	73	698ZZ	2pc	6	19	17	5	R19	698ZZ	2pc	6	19	
44						70.03	68.8	59	73												628ZZ
22	Z (Sides)			10	10	35.01	33.75	28	40	6000ZZ	2pc	8	26	24	3	R26	6900ZZ	6	22	20	
24						38.2	36.95	30	42												6200ZZ
25	Y (Centered)			12	12	39.79	38.55	34	47	6200ZZ	2pc	10	32	27	3.5	R32	6201ZZ	10	32	27	
26						41.38	40.15	37	49												6201ZZ
28	Z (Sides)			15	15	44.56	43.35	40	52	6200ZZ	2pc	10	32	27	3.5	R32	6201ZZ	10	32	27	
30						47.75	46.5	44	62												6302ZZ
32	AT5-25 A=27 W=32			Y (Centered)	8	50.93	49.7	30	45	6000ZZ	2pc	6	19	17	5	R19	698ZZ	2pc	6	19	
34						54.11	52.9	44	62												6201ZZ
35		Z (Sides)		10	10	55.7	54.45	34	47	6200ZZ	2pc	8	26	24	3	R26	6900ZZ	6	22	20	
36						57.3	56.05	45	65												6200ZZ
38		Y (Centered)		12	12	60.48	59.25	52.5	67.5	6202ZZ	1pc	11	35	30	5	R35	6202ZZ	11	35	30	
40						63.66	62.45	59	73												6202ZZ
42		AT5-25 A=27 W=32		Y (Centered)	8	66.85	65.6	59	73	698ZZ	2pc	6	19	17	5	R19	698ZZ	2pc	6	19	
44						70.03	68.8	59	73												628ZZ

* 10mm: (15*teeth) have two bearings °
 * 15mm: (18*~25*teeth) have two bearings °
 * 20mm: (18*~35*teeth) have two bearings °
 * 25mm: (18*~44*teeth) have two bearings °