

Steel plate high torque-long type

SW415

Clamping

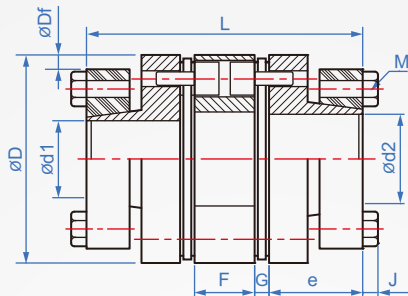

Ontology	disc-pin	Hexagon head screws
A6061 (white anode)	SUS	Steel+Ni

How to order

SW415 - 56 - 11x14
TYPE D d1xd2

unit : mm																		
D	L	Bore designation d1-d2	Df	F	e	G	J	M	screw Locking force	General torque (N · m)	Axial spring Spring number	Maximum number of spins (rpm/min)	moment of inertia (kg · m ²)	Allowable axis Displacement	Spring fixed number (N · m/rad)	allow eccentric	allow declination	quality (g)
56	60.8	10~17	4	3.9	20	13	5	8-M5	6	25	21.5	10000	14x10 ⁻⁵	0.8	8000	0.25	1°	308
		18~25	1															560
68	74.5	14~22	7	4.2	25	16	5.5	8-M6	12	60	22.5	10000	38x10 ⁻⁵	0.9	30000	0.3	1°	560
		24~30	2															855
82	85.6	16~30	9	4.8	30	22	5.5	8-M6	14	90	30	10000	107x10 ⁻⁵	0.9	35000	0.3	1°	855
		32~35	6.5															1500
94	100.8	19~30	13	9.4	30	22	5.5	8-M6	14	180	60	10000	195x10 ⁻⁵	1.6	70000	0.5	1°	1500
		32~48	8															1700
104	102	24~50	13	10	30	22	5.5	8-M6	14	250	80	10000	210x10 ⁻⁵	1.6	80000	0.5	1°	1700
		55~60	3															

Copyright © CHENA INDUSTRIAL CO.,LTD ALL RIGHTS Reserved.