

小徑低頭螺絲

WA732

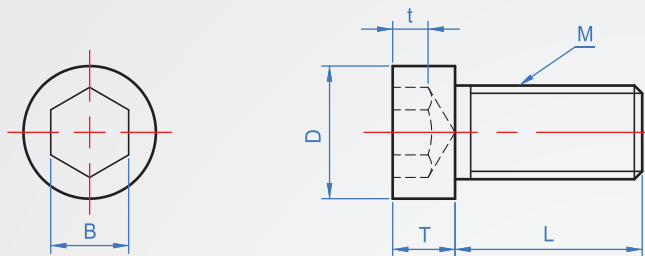

材質	表面處理	強度區分
SCM435 HRC22~32	染黑	8.8
A2 (相當SUS304)	—	A2-70

How to order



1

2

單位 :mm

M	Pitch 粗牙	L										D	小徑頭			
													B	T	t	
M3	0.5	5	6	8	10							4.5	2	2	1.5	
M4	0.7		6	8	10	12	16	20					5.5	2.5	2.8	2
M5	0.8			8	10	12	16	20					7	3	3.5	2.5
M6	1.0			8	10	12	16	20	25				8.5	4	4	3
M8	1.25				10	12	16	20	25	30			10	5	5	4
M10	1.5					16	20	25	30	35			13	6	6	4.5
M12	1.75						20	25	30				16	8	7	5

※強度區分是指螺牙的拉伸強度。

The term-strength rank-signifies the screw's tensile strength of the male screw parts.

8.8

8→代表降伏點或耐力的最小值為拉伸強度的80%。

Indicates that the yield point or the minimum proof strength is 80% of the tensile strength.

8→代表拉伸強度最小值為800N/m<sup>2</sup> {81.6kgf/m<sup>2</sup>}。

It indicates that the minimum value of nominal tensile strength 800N/m<sup>2</sup> {81.6kgf/m<sup>2</sup>}。

A2-50 / A2-70

50→代表拉伸強度的最小值為500N/m<sup>2</sup> {51kgf/m<sup>2</sup>}。

It indicates that the minimum value of nominal tensile strength is 500N/m<sup>2</sup> {51kgf/m<sup>2</sup>}。

70→代表拉伸強度的最小值為700N/m<sup>2</sup> {71kgf/m<sup>2</sup>}。

It indicates that the minimum value of nominal tensile strength is 700N/m<sup>2</sup> {71kgf/m<sup>2</sup>}。

A2→鋼種區分為A2(沃斯田鐵系不銹鋼)

The steel class is A2(Austenitic stainless steel)

※薄型化、小型化、省空間化

因應沉頭空間變小所開發設計的精工小商品

This delicately exquisite product is designed to be thinner, smaller and more space-saving