

Precision Lock Nut

YSF

Locking
Belly

※The locking method is a half-angle 30° angle and three-point locking.

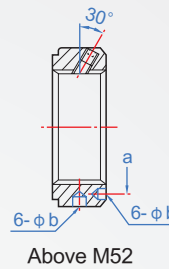
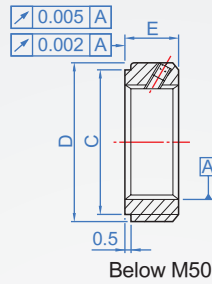
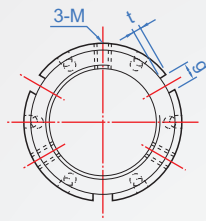

How to order

YSF - M14 - 1.5 -
 TYPE Screw Pitch
 Select thread accuracy
 Internal thread turning...
 Internal thread grinding.. G

Unit : mm

Screw	Pitch	D	C	E	g	t	a	b	M	Axial load Km	Locking torque max. Nm	Release torque Nm
M14	1.5											
M15	1	30	25	14						4.5	-	-
M16	1.5								M5 X 0.8		-	-
M17	1	32	27	16	4 (3 places)						80	27.5
M18	1.5										-	-
M20	1			16							90	28.9
M20	1.5					2					90	-
M22	1.5	38	33						M6 X 1.0	8	-	-
M24	1.5										-	-
M25	1.5										130	30.4
M27	1.5	40	35								-	-
M30	1.5	45	40	18	5 (3 places)				M8 X 1.25		160	32.4
M33	1.5	50	45								-	-
M35	1.5	52	47								190	39.2
M36	1.5A										-	-
M36	1.5	58	52								-	-
M40	1.5								M8 X 1.25	18	210	46.1
M42	1.5	62	56								-	-
M45	1.5	65	59	20	6 (3 places)	2.5					240	61.8
M48	1.5	70	64								-	-
M50	1.5										300	70.6
M52	1.5	73									-	-
M55	1.5		68								340	88.2
M56	2	75									-	-
M60	2	80	73	22	7 (3 places)	3					380	98
M64	2	85	78								-	-
M65	2							6			460	127.5
M68	2										-	-
M70	2	92	84						M8 X 1.25	18	490	147.1
M72	2	94	86								520	152
M75	2	98	90	24	8 (3 places)	3.5					-	-
M76	2										-	-
M80	2	105	96								620	156.9
M85	2	110	102		8 (6 places)						650	176.5
M90	2	120	108								680	186.3
M95	2	125	113	26							710	201
M100	2	130	118								740	220.6
M105	2	140	125								770	236.3
M110	2	145	132	28	10 (6 places)	4					800	252
M115	2	150	137								830	268.1
M120	2	155	142								860	279.4
M125	2	160	147	30							890	289.2
M130	2	165	152								920	313.7
M135	2	175	160								950	352.9
M140	2	180	165	32	12 (6 places)	5			M10 X 1.5	35	980	392.2
M145	2	190	175								1010	436.3
M150	2	195	180								1040	480.4
M155	3	200									1070	519.6
M160	3	210	190	34	14 (6 places)	6					1100	563.7
M165	3										1130	598
M170	3	220	200								1160	647.1
M180	3	230	205								1220	686.3
M190	3	240	215	36	16 (6 places)	7			M12 X 1.75	60	1280	735.3
M200	3	250	225	38							1340	794.1

Copyright © CHENA INDUSTRIAL CO., LTD ALL Rights Reserved.