

Hexagon socket head cap screws

ZC712

Cover type

Body material

SUS304

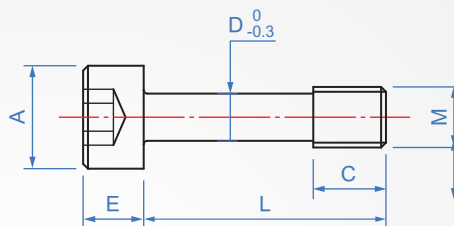

How to order

ZC712 - M5 - 6 - 20
 TYPE M C L

unit : mm														
1		2				3								
M	Pitch	C		L						A	E	B	D	
M3	0.5	4		8	10	12	15				5.5	3	2.5	2.2
M4	0.7	3	6	8	10	12	15				7	4	3	3
		5			10	12	15	20						
M5	0.8	3			10	12	15	20			8.5	5	4	3.9
		6				12	15	20						
M6	1	4				12	15	20			10	6	5	4.5
		8				12	15	20						
M8	1.25	5				12	15	20			13	8	6	6.3
		10						20	25	30				