

## Bar Pulley ED333

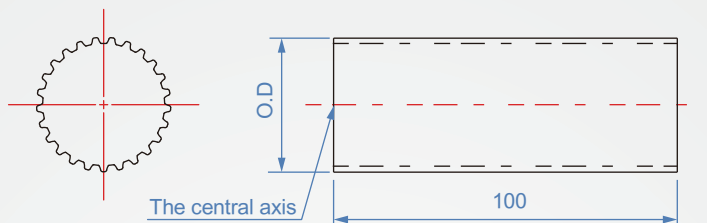

material	surface treatment
aluminum alloy	white anode

### How to order

ED333 - S3M - 20  
 TYPE      Kind      Belt teeth

Kind	Belt teeth	O.D		
		S2M	S3M	S5M
S2M 	14	8.4	12.61	21.32
	15	9.04	13.56	22.91
	16	9.68	14.52	24.5
	17	10.31	15.47	26.1
	18	10.95	16.43	27.69
	19	11.59	17.38	29.28
S3M 	20	12.22	18.34	30.87
	21	12.8	19.29	32.47
	22	13.5	20.25	34.05
	23	14.13	21.2	35.65
	24	14.77	22.16	37.24
	25	15.41	23.11	38.83
S5M 	26	16.04	24.07	40.42
	27	16.68	25.02	42.01

Belt teeth	O.D		
	S2M	S3M	S5M
28	17.32	25.98	43.6
29	17.95	26.93	45.19
30	18.59	27.89	46.79
31	19.23	28.84	48.38
32	19.86	29.8	49.97
33	20.5	30.75	51.56
34	21.14	31.71	53.15
35	21.77	32.66	54.74
36	22.41	33.62	56.34
37	23.05	34.57	57.93
38	23.68	35.53	59.52
39	24.32	36.48	61.11
40	24.96	37.44	62.7
41	25.59	38.39	64.29