

Pitch : 8.0mm

8YU

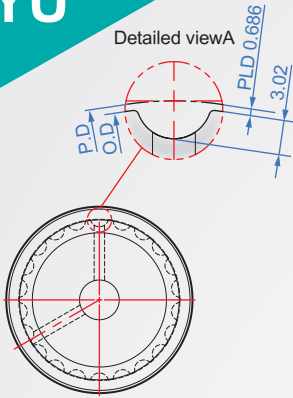

Width code	20	25	30	40	50	60	70	85
Common size	A=21.7 W=28 L=48	A=26.7 W=33 L=53	A=31.7 W=38 L=58	A=41.7 W=48 L=68	A=52.7 W=59 L=79	A=62.7 W=69 L=89	A=72.7 W=79 L=99	A=88.7 W=95 L=115

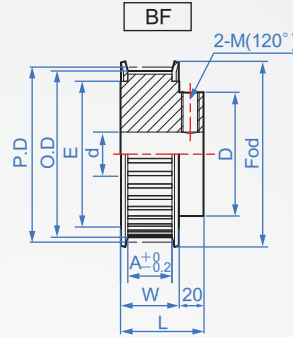
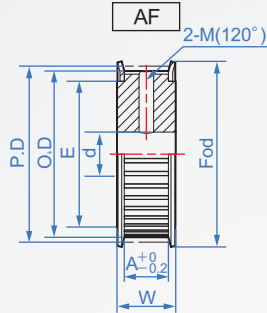

Material : Aluminum A6061+ anodized.
Please contact us if you need iron material.

How to order

1 20 - 2 8YU-20 - 3 BF - 4 H12 - 5

Number TYPE width Shape Hole shape of teeth

Choose surface treatment

- AS.....Clear anode
- AB.....Black anode
- AN.....Electroless nickel
- AK.....Hardened anode

BF shape can specify changes
Example: original D path 36, change 35. D35

Number of teeth	TYPE width	Shape	Hole shape	Aperture d Processing min.	P.D	O.D	Number of teeth	D	E	Fod	Unit : mm																													
20	8YU-20	AF	H Round hole 	12~	50.93	49.56	20	36	40	55																														
21					53.48	52.1	21	40	43	60																														
22					56.02	54.65	22	40	44	62																														
23					58.57	57.2	23	42	45	65																														
24					61.12	59.74	24	44	50	70																														
25					63.66	62.29	25	46	55	70																														
26					66.21	64.84	26	48	60	80																														
27					68.75	67.38	27	50	65	85																														
28					71.3	69.93	28	52	70	90																														
29					73.85	72.48	29	54	75	95																														
30					76.39	75.02	30	56	80	100																														
31					78.94	77.57	31	58	85	105																														
32	8YU-25	BF	Round hole + tapping P (120°) PV (90°) 	16~	81.49	80.12	32	60	70	90																														
33					84.03	82.66	33	62	75	95																														
34					86.58	85.21	34	64	80	100																														
35					89.13	87.56	35	66	85	105																														
36					91.67	90.3	36	68	90	110																														
37					94.22	92.85	37	70	95	115																														
38					96.77	95.39	38	72	100	125																														
39					99.31	97.94	39	74	105	130																														
40					101.86	100.49	40	76	110	135																														
41					104.41	103.03	41	78	115	140																														
42					106.95	105.58	42	80	120	146																														
43					109.5	108.13	43	82	125	152																														
44	8YU-30	AF	Keyway + Tapping N (120°) NV (90°) 	20~	112.05	110.67	44	84	128	160																														
45					114.59	113.22	45	86	135	165																														
46					117.14	115.77	46	88	140	170																														
47					119.68	118.31	47	90	145	175																														
48					122.23	120.86	48	92	150	180																														
49					124.78	123.41	49	94	155	185																														
50					127.32	125.95	50	96	160	190																														
51					129.87	128.5	51	98	165	195																														
52					132.42	131.04	52	100	170	200																														
53					134.96	133.59	53	102	175	205																														
54					137.51	136.14	54	104	180	210																														
55					140.06	138.68	55	106	185	215																														
56	8YU-40	BF	Shaft bore kw(Js9) kh Tapping <table border="1"> <tr><td>11-12</td><td>4</td><td>1.8</td><td>M4</td></tr> <tr><td>13-17</td><td>5</td><td>2.3</td><td>M5</td></tr> <tr><td>18-22</td><td>6</td><td>2.8</td><td>M6</td></tr> <tr><td>23-30</td><td>8</td><td></td><td></td></tr> <tr><td>31-38</td><td>10</td><td>3.3</td><td>M8</td></tr> <tr><td>39-44</td><td>12</td><td></td><td></td></tr> <tr><td>45-50</td><td>14</td><td>3.8</td><td>M10</td></tr> </table>	11-12	4	1.8	M4	13-17	5	2.3	M5	18-22	6	2.8	M6	23-30	8			31-38	10	3.3	M8	39-44	12			45-50	14	3.8	M10	20~	142.6	141.23	56	90	157	188		
11-12				4	1.8	M4																																		
13-17				5	2.3	M5																																		
18-22				6	2.8	M6																																		
23-30				8																																				
31-38				10	3.3	M8																																		
39-44				12																																				
45-50				14	3.8	M10																																		
57				145.15	143.78	57	92	160	190																															
58				147.7	146.32	58	94	165	195																															
59				150.24	148.87	59	96	170	200																															
60				152.79	151.42	60	98	175	205																															
70	178.25	176.88	70	100	180	210																																		
72	183.35	181.97	72	102	185	215																																		
80	203.72	202.35	80	104	190	220																																		
90	229.18	227.81	90	106	195	235																																		
100	254.65	253.28	100	108	200	240																																		

Copyright © CHENA INDUSTRIAL CO., LTD ALL RIGHTS RESERVED.