

Resin coupling-Oldham

## CH433 Clamp type



Main part

A6061  
(Clear anodizing)

Cushioning material

Engineering plastics

Hex socket head cap screws

SCM435  
(Black oxide)

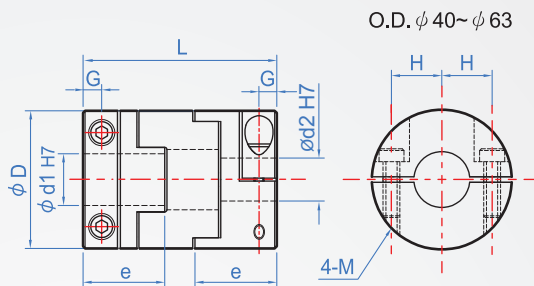
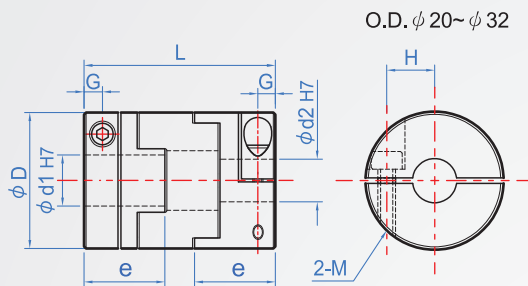

How to order

CH433 - 16 - 4x5  
 TYPE D d1xd2

D	d1、d2		L	G	e	M	H	Quality (g)	Torque (N · m)	Max. torque (N · m)	Highest number of rotations (rpm/min)	Moment of inertia (kg · m <sup>2</sup> )	Allowable eccentric (mm)	Allowable declination (°)	Unit : mm	
	min.	max.														
16	4	~ 6.35	29	3	13	M2.5	5	12	0.7	1.4	9500	$5.8 \times 10^{-7}$	1	3		
20	5	~ 8	33		15	M3	6.5	19	1.2	2.4	7600	$1.5 \times 10^{-6}$	1.5			
25	5	~ 10	39	3.8	18		9	36	2	4	6100	$4.4 \times 10^{-6}$	2			
32	6	~ 14	45	4.5	20	M4	11	69	4.5	9	4800	$1.4 \times 10^{-5}$	2.5			
40	8	~ 16	50	7	22.5	M5	13	130	9	18	3800	$4.1 \times 10^{-5}$	3			
50	12	~ 22	58	8	26.5	M6	16	230	18	36	3100	$1.2 \times 10^{-5}$	3.5			
63	15	~ 25	71	10	32.5	M8	21	450	36	72	2400	$3.7 \times 10^{-4}$	4			