

Dustproof ball roller

BR814

Thread bolt

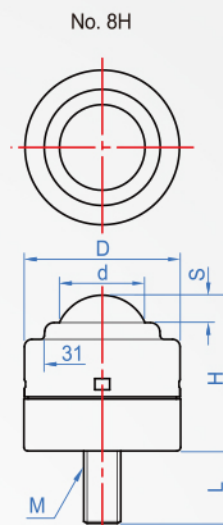
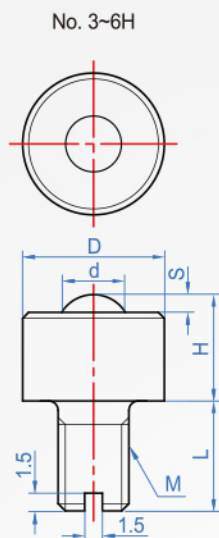

How to order

BR814 - C-5H
 TYPE Code

Unit : mm											
Allowable load	Code	Main ball	Auxiliary ball	Main part	Weight (g)	H	L	S	D	M	d
8kg	C-3H	Steel	Steel	Steel	18	15	12	2.5	15	M6	3/8"Ball
	S-3H	SUS	SUS	SUS	18						§ 9.525
20kg	C-5H	Steel	Steel	Steel	55	20.5	12	4	24	M6	5/8"Ball
	S-5H	SUS	SUS	SUS	54						§ 15.875
50kg	C-6H	Steel	Steel	Steel	126	26	20	4	32	M8	3/4"Ball
	S-6H	SUS	SUS	SUS	124						§ 19.05
80kg	C-8H	Steel	Steel	Steel	337	42	21	7.4	42	M10	1"Ball
	S-8H	SUS	SUS	SUS	330						§ 25.4

Note