

Aluminum alloy handle

HA946

Heavy load

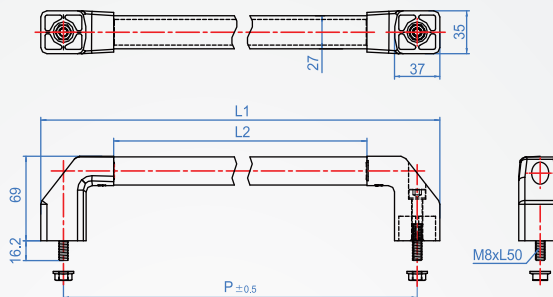

Material and finish

- Holder : Polyamide (PA6-GF33),Black.
- Handle : Aluminum alloy (6063),Anodized in natural or black color.
- Load Capacity : 450 N/pcs

Features

- Could be quick installed on the panel with a tapped hole or with a normal hole by nut.
- Tight the screw from outside,working space is not effected by cabinet inner space.
- Weathering resistance of PA holder is -20°C~+150°C
- Holder attach M8*L50 screw, the outlook is artistic.
- Resistance to acid, alkali, greasiness.

How to order

HA946 - 180

TYPE P



Unit : mm

P	L1	L2	Weight (g)
180	217	98	290
250	287	168	344
300	337	218	377
350	387	268	420
400	437	318	458
500	537	418	531