

KG-Keyless Pulleys

AT5

Pitch 5mm

Keyless Pulleys

Extra over product

Final product



Y Bulge Type

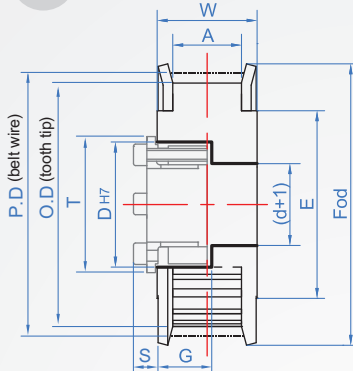

Z Bury Type

When $(S+1)+G \geq W$ the bottom in through hole.

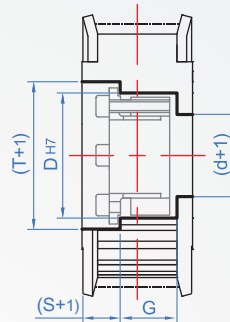

※KG series does not include the power lock. Please select in LP458 series if necessary.



Main Part	Flang	Finish
A6201	Aluminum	AS Clear anodizing
		AB Black anode
		AK Electroless nickel
		AN Electroless nickel
S45C	Iron	TB Black oxide
		TN Electroless nickel

How to order

KG - 32 - AT5-20 - Y12 -

1 TYPE Number of teeth
2 Tooth width
3 Wheel width

Material and finish chosen

A6201+Clear anodizing.....	<input type="checkbox"/> AS
A6201+Black anode.....	<input type="checkbox"/> AB
A6201+Hard anodized.....	<input type="checkbox"/> AK
A6201+Electroless nickel.....	<input type="checkbox"/> AN
S45C+Black oxide.....	<input type="checkbox"/> TB
S45C+Electroless nickel.....	<input type="checkbox"/> TN

Number of teeth	Tooth width	Wheel	Type Y Applicable for aperture d				Type Z Applicable for aperture d			Number of teeth	P.D	O.D	E	Fod											
			10	15	20	25	15	20	25																
20	AT5-10 (A=11 W=16)	Bulge type Y	8	8	8	8	-	-	-	20	31.83	30.6	24	35											
22			8~10	8~10	8~10	8~10	8	8	8	22	35.01	33.75	28	40											
24			8~12	8~12	8~12	8~12	8~10	8~10	8~10	24	38.2	36.95	30	42											
25															25	39.79	38.55	45							
26			8~16	8~16	8~16	8~16	8~10	8~10	8~10	26	41.38	40.15	34	47											
28															28	44.56	43.35	37	49						
30			8~19	8~19	8~19	8~19	8~12	8~12	8~12	30	47.75	46.5	40	52											
32															32	50.93	49.7	55							
34			AT5-15 (A=17 W=22)	Bulge type Y	8~12	8~12	10~22	10~22	8~12	10~19	34	54.11	52.9	44	62										
36																36	57.3	56.05	45	65					
38	10~25	10~25														10~25	10~19	8~12	8~12	8~12	38	60.48	59.25	52.5	67.5
40																									
42	10~25	10~25														10~25	10~19	8~12	8~12	8~12	42	66.85	65.6	58	71
44																									
46	10~30	10~30														12~30	10~19	10~25	10~25	10~25	46	73.21	72	60	80
48																									
50	10~30	10~30														14~35	10~19	10~25	10~25	10~25	50	79.58	78.35	65	85
60																									
70	10~30	10~30	14~50	10~19	10~30	10~30	10~30	70	111.41	110.2	98	118													
72													72	114.59	113.35	110	135								
80	10~30	10~30	14~60	10~19	10~30	10~30	10~30	80	127.32	126.1	110	135													
90													90	143.24	142.05	120	146								
100	100	159.15	157.95	130	165																				

※CheNa can also design and manufacture parts other than the number of teeth and shaft diameter in the above table.

LP458 shaft sleeve size table

Unit : mm

d	8	10	12	14	15	16	18	20	22	24	25	28	30	32	35	38	40	45	50	55	60	65
D	21	23	26	28	29	30	32	38	40	42	43	46	48	50	57	60	62	67	72	77	82	87
G	15		18				22		23	24			25	27		28		29				
S	6		6.5				8				8.5			10			10.5		11			
T	23.5	25.5	28.5	30.5	31.5	32.5	34.5	42	44	46	47	50	52	54	62	65	67	72	77	83	87	92