

Rotary handle  
**HA940**  
Column type

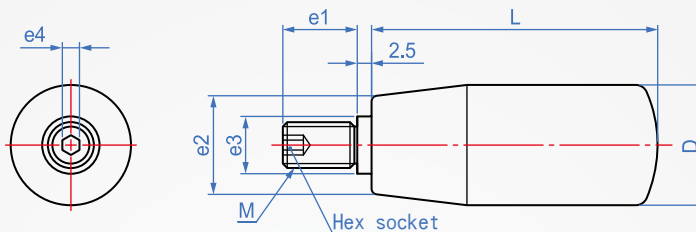

Handle	Axis	
	Material	Finish
Black bakelite	S45C	Galvanization

How to order

HA940 - M6 - 40  
 TYPE      M      L

							Unit : mm
M	L	D	e1	e2	e3	e4	Reference weight (g)
*M6	28	14	10	10	3	3	20
M6 、 1/4"	40	18	12	15	10		30
M6	50	21	13	17			42
M8	50	23	14	19	13	4	45
M8 、 5/16"	65						80
M8	80						110
M10	65	23	14	19		5	80
M10 、 3/8"	80	26	16	21			110
	90	28		22			125

\*Center cover material is SUS