

Cylinder bore 15、18
YA102
Steel

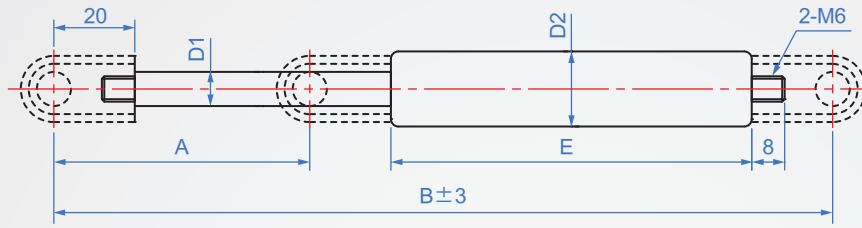

Axis	Outer tube	Gas	Surface treatment	Operating temperature
S45C (Nitrided black)	STKM11A	Nitrogen	Black paint	-20°C~60°C



How to order

YA102 - 15040 - A-B - 50N

TYPE No. Connector pressure

No.	Connector	Scope of production (F1 pressure value)	A	B		E	D1	D2	Weight (g) Does not include connectors
				max	min				
15040		50~400N	40	159	119	77	6	15	60
15060			60	199	139	95			70
15080			80	240	160	120			76
15090			90	255	165	125			81
15100			100	280	180	140			92
15120	A		120	321	196	156			100
15150	B		150	380	230	190			116
18060	C		60	205	145	105			96
18080		80	245	165	125	113			
18100	D	100	295	195	155	131			
18125	E	125	330	205	165	145			
18148	F	148	375	227	187	163			
18165		165	405	240	200	176			
18177	(Short connector) *L	100~700N	177	430	253	213	8	18	185
18185			185	450	265	225	201		
18200			200	485	285	245	211		
18210			210	500	290	250	216		
18225			225	525	300	260	228		
18250			250	585	335	295	251		
18275			275	630	355	315	272		

*The L connector in the above table is a short connector. If this connector is selected, its maximum length and minimum length must be deducted by 4mm.
9.8N = 1Kg = 2.2BLS

■ Install both ends of the joint

A

Material : 12L14
Surface treatment :
Black EP

B

Material : NYLON PA-6
(Black Nylon)

C

Material : NYLON PA-6
(Black Nylon)

D

Material : NYLON PA-6
(Black Nylon)

E

Material : A6061
Surface treatment :
White anode

F

Material : ALSI 12L14
Surface treatment :
Black zinc plating

L

Material : 12L14
Surface treatment :
Black EP

Connector	With YA103 support
A、B、C、L	H0、H1、H2、H3
D、E	H4、H5、H6
F	H7、H8