

Loosening Prevention Washers

# NL787

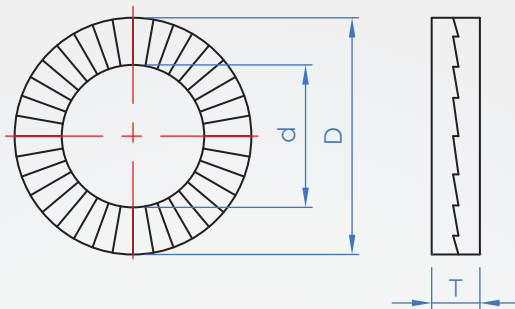

Material	Hardness
Galvanized steel	HRC50
SUS316	

※Heat resistant temperature is 500° C

How to order

NL787 - M3 -   
TYPE No.

Select material  
 Galvanized steel...   
 SUS316.....  SUS

Applicable bolt		d	D	Thickness T	
Metric	(Inch system)			Galvanized steel	S316
M3	( #5 )	3.4	1.8	2.2	
M4	( #8 )	4.4			
M5	( #10 )	5.4			
M6	-	6.5			
1/4	( 1/4" )	7.2	2.5		
M8	( 5/16" )	8.7			
3/8	( 3/8" )	10.3			
M10	-	10.7			
M12	-	13	3.4		
1/2	( 1/2" )	13.5			
M14	( 9/16" )	15.2			
M16	( 5/8" )	17			
M18	-	19.5			
3/4	( 3/4" )	20			
M20	-	21.4			
M22	( 7/8" )	23.4			
M24	-	25.3	32		

※The galvanized steel material has a larger size corresponding to M130, please contact the service window.

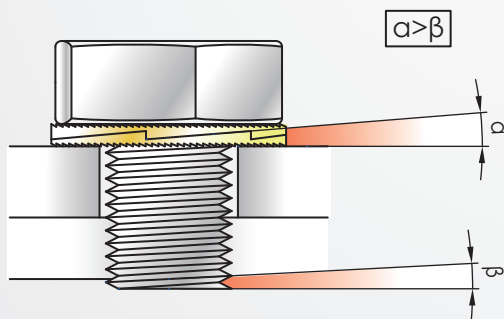

In each group, there are different serrations on the top and bottom. The large sawtooth has an inclination  $\alpha$  larger than the bolt thread angle  $\beta$ . The small serrated surfaces are connected to the nut and the female component respectively, and after fastening the fasteners that are connected with the bolts, when the vibration occurs, the large tooth surfaces lock the bolt, so as not to loose.

Use examples

