

Cylinder bore 22、28

YA102

Steel



Axis	Outer tube	Gas	Surface treatment	Operating temperature
S45C (Nitrided black)	STKM11A	Nitrogen	Black paint	-20°C~60°C

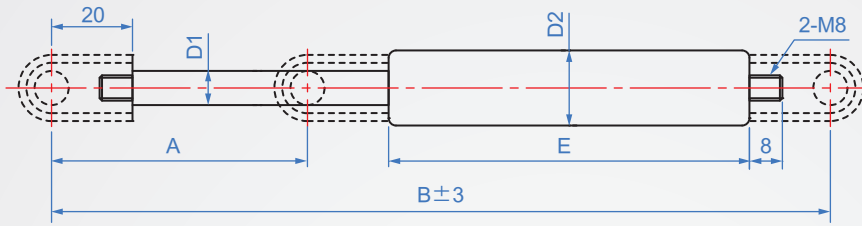

How to order

YA102 - 22100 - G-H - 100N

TYPE No. Connector pressure

No.	Connector	Scope of production (F1 pressure value)	A	B		E	D1	D2	Weight (g) Does not include connectors
				max	min				
22100	G H I	100~1150N	100	285	185	145	10	22	212
22125			125	330	205	165			245
22150			150	385	235	195			284
22160			160	405	245	205			297
22180			180	450	270	230			328
22200			200	485	285	245			353
22210			210	500	290	250			363
22220			220	525	305	265			381
22250			250	585	335	295			420
22280			280	670	390	350			490
22300			300	700	400	360			500
22330			330	750	420	380			537
22350			350	785	435	395			562
22370			370	830	460	420			591
22400			400	885	485	445			630
28100	(Long) *K	300~2500N	100	325	225	165	14	28	446
28150			150	425	275	215			574
28200			200	525	325	265			703
28250			250	625	375	315			830
28300			300	725	425	365			958
28350			350	825	475	415			1087
28400			400	925	525	465			1212
28500			500	1125	625	565			1470

*The K connector for the 28mm cylinder diameter in the table above is a long type. If you want to shorten the length, you can also choose a short connector J.
9.8N = 1Kg = 2.2BLS

■ Install both ends of the joint

G Material : ALSI 12L14
Surface treatment : Black

H Material : A6061
Surface treatment : White anode

I Material : A6061
Surface treatment : White anode

J (Short connector) Material : Die-cast zinc alloy
Surface treatment : White zinc plating

K Material : ALSI 12L14
Surface treatment : Black

Connector	With YA103 support
G	H7、H8、H9
H、I	H4、H5、H6
J	H6
K	H10