

Universal Joint
SJ461 Extended Type

Material	Finish
SCM415 Charcoal burning	Dye black (Appearance grinding)

Accessories for round holes : Fixed pin, elastic ring
Accessories : Stop screw

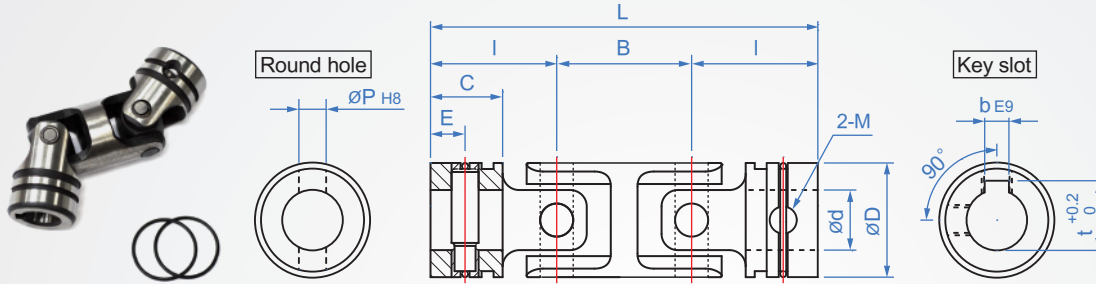

How to order

SJ461 - 14 -

TYPE d

Select shaft hole type

Round hole..... A

Keyway..... B

Round hole + keyway.... C

Allowable angle of action : 30°

													unit : mm			
d	Shaft hole type	D	B	L	I	C	E	P	b	t	M	G	weight (g)	Allowable torque N • m	Allowable speed min-1	Destruction of torque N • m
6	A Bilateral round hole	12	18.5	49.5	15.5	9	4.5	3	-	-	-	-	30	3.96	2500	12
8		15	22	58	18	10	5	3.5	3	9.5	M3	26	50	8.58	2200	26
10		19	25.5	67.5	21	12	6	4.5	4	11.5	M5	32	95	20.1	2000	61
12		23	31	83	26	15	7.5	5	4	13.5	M5	36	180	33	1800	100
14		26	35.5	94.5	29.5	17	8.5	5.8	5	16	M6	40	250	46	1600	140
16	B Bilateral keyway	30	43.5	117.5	37	22	11	6.5	5	18	M6	46	410	76	1400	230
18		33	48	129	40.5	23.5	11.75	7	5	20	M6	52	550	96	1200	290
20		36	52	139	43.5	25	12.5	8	5	22	M6	58	690	129	1000	390
22		40	56	150	47	27	13.5	9	7	25	M6	62	940	185	900	560
25	C Round hole + keyway	44	63	168	52.5	30	15	10	7	28	M8	68	1240	248	800	750
30		51	73	195	61	35	17.5	11.5	7	33	M8	82	1775	363	700	1100
35		59	84	224	70	40	20	13	10	38.5	M10	90	3180	594	600	1800
40		67	94	251	78.5	45	22.5	14.5	10	43.5	M10	100	4150	891	500	2700
45		75	106	282	88	50	25	16	12	48.5	M10	110	6225	1155	400	3500
50		83	113	304.4	95.7	55	27.5	17.5	12	53.5	M10	120	7750	1419	300	4300

※ The allowable torque value in the table is 1/3 of the breaking torque and 0° when the static load is 0° .