

Flange - Steel pin
PP634

Type	Main part	Pin	
		Material	Finish
Light load L	S45C HRC29~35 (Black oxide)	S45C	Trivalent chromium
Heavy load H		HRC57~63	Black oxide

Spring : SWP-B

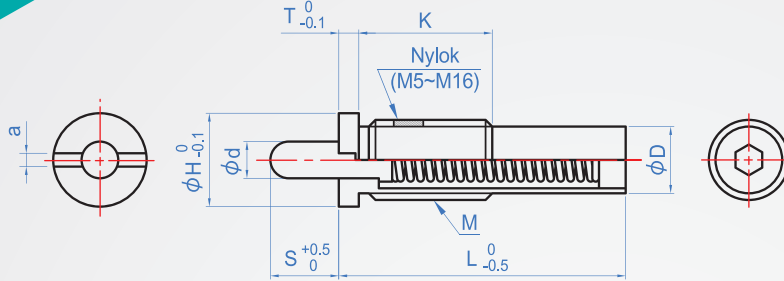

How to order

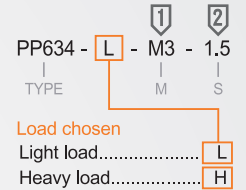

M Coarse thread	S	L	d	D	H	K	T	a	Load (N)				Applicable spanner
									Light load L		Heavy load H		
									min.	max.	min.	max.	
M3	1.5	10	1.1	2.35	5	5	1.5	0.5	0.49	1.0	0.78	2.9	Flathead screwdriver
	3	15							0.29	1.0	0.78	2.9	
M4	2	15	1.6	3.1	6	6	1.8	0.7	1.0	2.0	2.9	8.8	P-1
	4	24							0.59	2.0	2.0	8.8	
M5	3	20	2	3.8	7	8	2	1.2	2.0	9.8	4.9	19.6	P-2A
	5	27							2.0	9.8	2.9	19.6	
M6	3	25	2.5	4.7	8	9	2.5	1.5	5.9	9.8	7.8	29.4	P-3
	5	30							2.0	9.8	4.9	29.4	
M8	3	25	3.1	6.1	10	12	3	2	5.9	9.8	14.7	29.4	P-4
	5	27							2.9	9.8	7.8	29.4	
M10	5	30	3.8	7.5	12	15	3	2	5.9	14.7	8.8	49.0	P-3
	10	43							2.9	14.7	7.8	49.0	
M12	5	30	5.5	9.2	14	20	3	2	5.9	14.7	18.6	49.0	P-4
	10	43							2.9	19.6	7.8	49.0	
M16	15	51	8	13	18	25	3	2	2.9	19.6	4.9	49.0	P-4
	10	60							5.9	39.2	12.7	78.5	
	15	60							3.9	39.2	12.7	78.5	
	20	85							4.9	39.2	9.8	78.5	
	30	125							2.9	39.2	6.9	78.5	
	40	125							4.9	39.2	6.9	78.5	

※M3、M4 have not Nylok.

Load N × 0.101972 = Load (kgf)