

3/2 way AT195

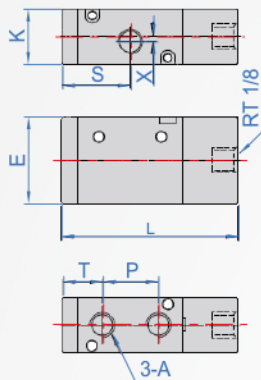

10 : Single solenoid



20 : Double solenoid

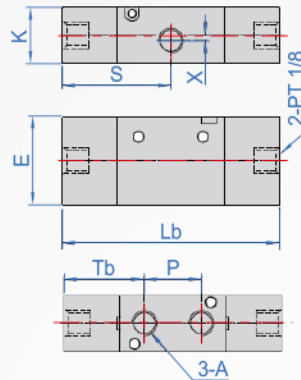

Material of body	Operating pressure	Proof pressure	Temperature °C
Aluminum alloy	0.15~0.8Mpa (21~114psi)	1.5Mpa (215psi)	-20°C~70°C

※ Product feature :

1. Structure in sliding column mode : good tightness and sensitive reaction.
2. Double air control valves have memory function.
3. Internal hole adopts special processing technology which has little attrition friction, low start pressure and long service life.
4. No need to add oil for lubrication.
5. Multi-mounting helps to install and apply.
6. Integrate with the manifold to save installation space.

※ Symbol

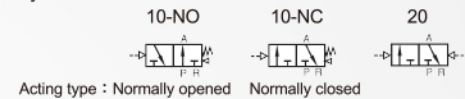

How to order



Unit : mm

No.	Valve	PT	Cv	cycle/sec	L	S	T	Lb	Sb	Tb	A	E	K	P	X
6	(Single solenoid)	Intake=Exhaust=1/8"	0.67 (12mm ²)	5	57.7	23.7	14.7	70	36	27	1/8"	27	18	16	2
8	(Single solenoid)	Intake=Exhaust=1/4"	0.89 (16mm ²)	5	69.7	28.7	16.5	84	43	30.8	1/4"	35	22	22.5	1.5
10	(Double solenoid)	Intake=Exhaust=3/8"	1.67 (30mm ²)	5	80.5	32.5	20.5	96	48	36	3/8"	40	27	24	2

※Flow coefficient Cv is calculated using the coefficient, US、JP use Cv, European use Kv, UK use fp. (1Kv=14.28 Cv)
 ※The maximum actuation frequency is in the no-load state.

Note